

EXAMPLE OF SWIMMING  
POOL PLACEMENT (RIGHT REAR)

SCHEDULE 1133.08(a)(1)

MINIMUM SETBACKS: FRONT LOT LINE N/A  
MINIMUM SETBACKS: SIDE LOT LINE 10'  
MINIMUM SETBACKS: REAR LOT LINE 10'

SCHEDULE 1133.08(b)

MAXIMUM REAR YARD COVERAGE OF ALL  
ACCESSORY BUILDINGS AND STRUCTURES,  
INCLUDING DECKS, PAVEMENT, PATIOS  
AND POOLS IS 60%

ALL SWIMMING POOLS, TOGETHER WITH  
ADJACENT WALKWAYS, SHALL BE ENCLOSED  
BY A WALL OR FENCE HAVING A MINIMUM  
HEIGHT OF 5'

FOR ABOVEGROUND POOLS, THE HEIGHT OF  
THE POOL, FROM THE SURROUNDING GRADE  
TO THE TOP OF THE POOL WALL, MAY BE USED  
AS CREDIT TO MEET THE MINIMUM 5' HEIGHT  
REQUIREMENT

ALL FENCES AND OTHER POOL ENCLOSURES  
SHALL BE CONSTRUCTED SO AS TO HAVE  
NO OPENINGS, HOLES, OR GAPS LARGER THAN 3"  
IN WIDTH, EXCEPT FOR DOORS, GATES OR  
WINDOWS WHICH SHALL BE EQUIPPED WITH  
SUITABLE LOCKING DEVICES TO PREVENT  
UNAUTHORIZED ACCESS. ACCESS SECURED  
ACCESSORY BUILDINGS AND WALLS OF  
PRINCIPAL BUILDINGS MAY BE USED IN PLACE OF,  
OR PART OF, THE ENCLOSURE  
A LIVING FENCE SHALL MEET THE REQUIREMENTS  
FOR AN ENCLOSURE WHEN THE PLANTS ARE  
CLOSELY SPACED SO AS TO PREVENT UNAUTHORIZED  
ACCESS TO THE POOL AREA  
THE CONSTRUCTION AND OPERATION OF THE POOL  
SHALL MEET ALL OTHER CITY REGULATIONS

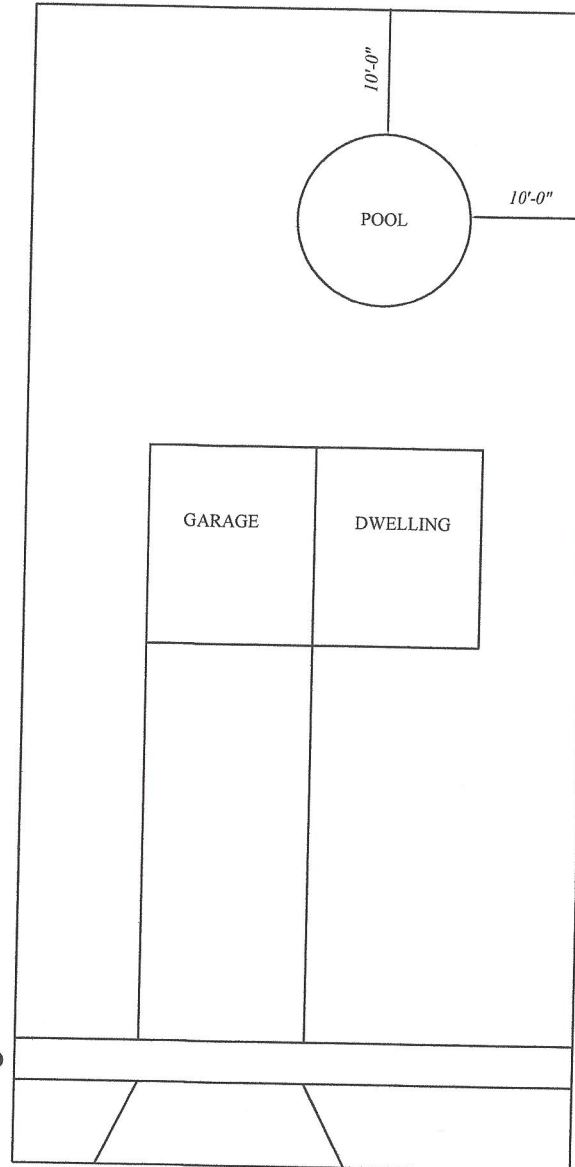

PLEASE PROVIDE FENCE  
APPLICATION

PLEASE PROVIDE  
ELECTRICAL APPLICATION

PLEASE PROVIDE  
HVAC APPLICATION  
(POOL HEATER)  
(IF APPLICABLE)